

Where this X mark is placed belonging to Eleazar Gilbert.

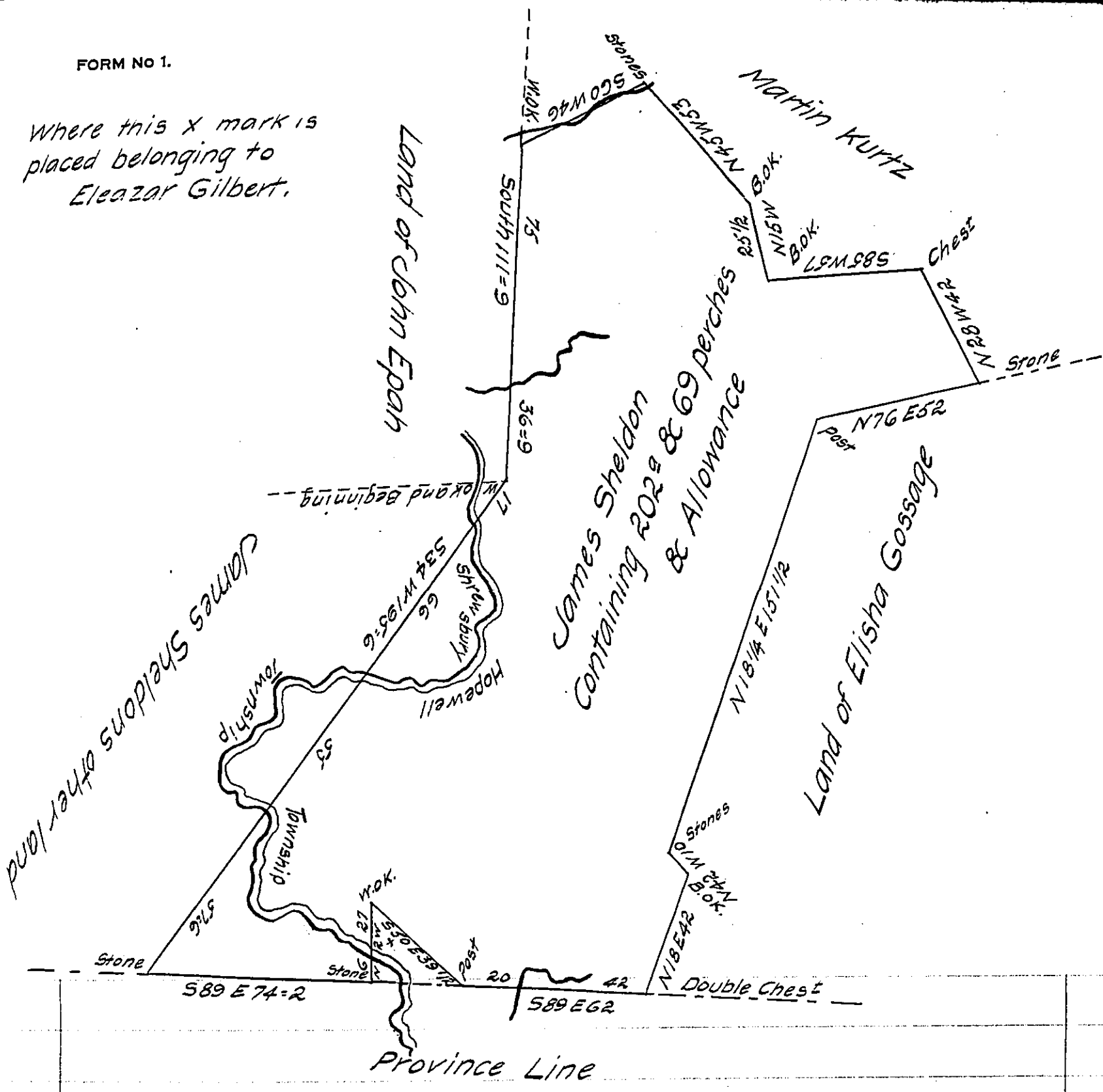

Situate the greater part in Hopewell Township and a Small part in Shrewsbury Township in the County of York Containing as above set forth 202^{2/3} & 69 perches Which was Originally Surveyed by John Eichelberger late DS in September AD^o 1802 In Pursuance of a Warrant for 200^{2/3} granted to James Sheldon bearing date the 1st day of April AD^o 1802 And now on the 18th day of March AD^o 1813 Resurveyed by the old lines at the request of James Sheldon Who desired the Same to be Returned for Confirmation.

To Richard T. Leech Esquire } per Jacob Spangler D.S.
 Surveyor General }
 Harrisburg Pa }

IN TESTIMONY that the above is a copy of the original remaining on file in the Department of Internal Affairs of Pennsylvania, made conformably to an Act of Assembly approved the 16th day of February, 1833, I have hereunto set my Hand and caused the Seal of said Department to be affixed at Harrisburg, this Twentieth day of December 1906.

Loac B. Downey
 Secretary of Internal Affairs.